

SR-36 (Main Street) and Skyline Drive

Proposed New Traffic Signal and Raised Median

Tooele City, in partnership with the Utah Department of Transportation (UDOT), is proposing a project to construct a raised median along SR-36 (Main Street) from Skyline Drive to just south of 520 South (see map below).

If constructed, the raised median would restrict left turns on and off Main Street at 520 South. Additionally, access to the Go-fer gas station from Main Street would be restricted to a right-turn in/right-turn out only. The City's goal is to reduce traffic conflict points, promote driver awareness, and improve safety in this area to support UDOT's vision of zero crashes, injuries, and fatalities on Utah roads.

The proposed improvements would also include the installation of a new traffic signal at the Skyline Drive/Main Street intersection, just north of the raised median, along with crosswalks on the north and east legs of the intersection to improve pedestrian access and safety.

Signal installation would require the closure of Sunny Center Daycare's southern driveway access off Main Street, but the northern driveway access would remain open.

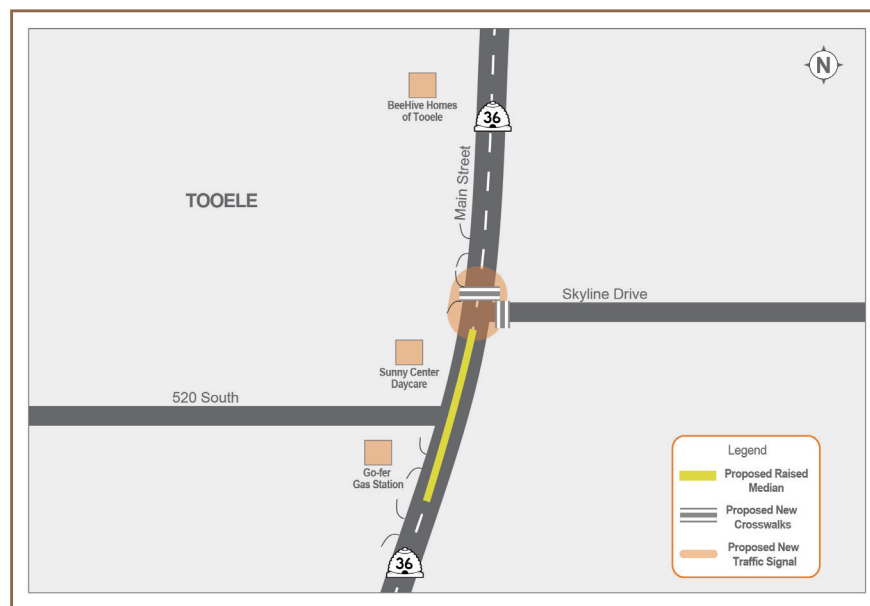

Tooele City and UDOT advise that all persons or groups interested in the proposed improvements can request a public hearing be held, provided the request is received by February 18, 2026.

HOW DO I SUBMIT A REQUEST?

Requests, or written statements concerning the project, can be emailed to udotregion2@utah.gov, or sent by mail to 38 E. Scenic Pointe Drive, Suite 300, Draper, UT 84020, C/O Ashlie Albrecht, so long as they are postmarked by February 18, 2026.

If you do not wish to request a public hearing but still have questions or want to submit a comment about the project, please reach out to our public involvement team using the contact information below.